

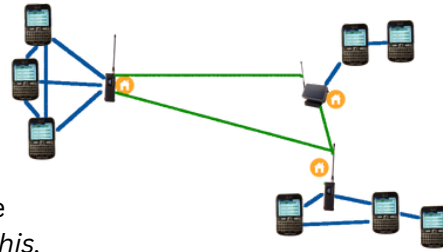

Onboarding a Communicator

What is a Cluster?

A group of **up to 90 fully trusted devices** that securely communicate using encryption, digital signatures, and frequency hopping.



What is Onboarding?

Adding a new trusted device to your cluster. This needs to be done one time for each device. *Only the root device can do this.*

1. Ensure No Other Devices are Onboarding Nearby

If any other device is in Join Mode or Onboard Mode, interference may occur and the onboard may not be successful (or you may onboard the wrong device).

2. Put the Root device in *Onboard Mode*

Select *Settings / Cluster / Onboard Device*

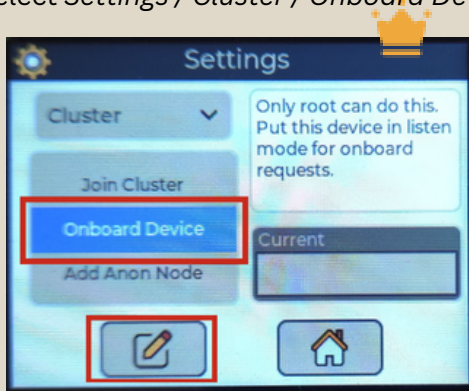

3. Put the new device in *Join Mode*

Select *Settings / Cluster / Join Cluster*

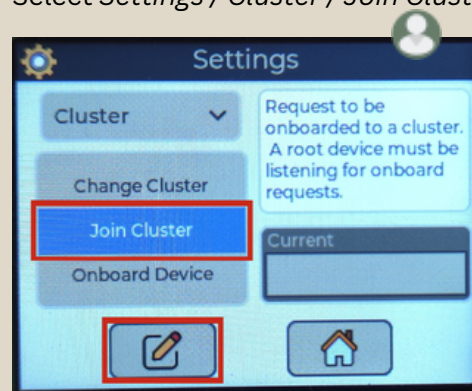

3. Wait a Minute or Two

During onboarding, the devices are exchanging a lot of info so the new device can communicate securely with your cluster.



If it takes more than a few minutes and seems frozen, you can safely restart both devices and onboard again.

4. Allow Your Cluster to Stabilize

If your cluster has several or many existing devices, those existing devices will need to learn to trust the new device.



Other communicators may temporarily show the new devices as *Unidentified*. This means trust has not yet been established between the two devices. It should clear up automatically within minutes.



[Optional] Speed up Stabilization

You can speed up the trust/learning process by choosing "Broadcast Identity" from the newly trusted device. This causes it to broadcast its public key to all devices within range, kicking off the trust process.

