



ChatterBox Channels

ChatterBox provides the following two ways to group devices

Private Cluster

- Maximum privacy, security, and functionality
- Each device must be onboarded by root
- Signed delivery confirmation
- Direct messages & broadcasts
- Cluster-wide state, position tracking, and more
- 90 device limit (*with certain exceptions*)

Open Channels

- Unlimited number of devices
- A channel is created/joined by having a channel ID and series of passwords
- Encryption, digital sig, and frequency hopping
- Only broadcast messages are supported
- Location can be shared

Max Expiration 2 Hours
Delivery attempts will continue until expiry

Current Channel **Broadcast a Message**

Message To: [broadcast]
Expiry: 10 Minutes Max allowed packet delivery time. Default is usually OK (see docs).
Type your message
Add GPS + Nodes

Add your location to the message? **Should Nodes Display?**

Green = You Have Neighbor(s)
Touch to view pings

grant @ Public 03/05/25 11:06
[All Devices] [flash] ok 03/03 17:23
[flash] another test 03/03 17:15
LoRa@917.2 S+ Mesh Cache

Add other devices on the view
(only available on YOUR location)

Filter other devices from the view

Latest Position of device named at the top

Map Scale

Scannable QR Map Link **Map View** (currently shown) **Your Position and Course Over Ground**
Walk for a moment to get your heading

Location Of: guest Live North 2 km
Last Position
Lat: -40.653360
Long: -84.969492
Altitude: 268 m
As of: 02/07/25 12:53
Latest Movement
Heading: -41.4
Speed: 1 km/h
Relative To You
[self location]

guest shar

LoRa@915.2 S+ Mesh Cache

grant @ Public 03/05/25 11:05
[All Devices]

Recent Pings:
03/05 11:04 [200] RSSI: -50
03/05 11:02 [200] RSSI: -54
03/05 11:02 [200] RSSI: -50
03/05 11:00 [200] RSSI: -49
03/05 10:59 [200] RSSI: -51
03/05 10:58 [200] RSSI: -43

LoRa@915.2 S+ Mesh Cache



Setting Up a Channel

Communicators can have 2 channels configured. Nodes can only have one. **A channel is really just a unique alphanumeric Channel ID and a series of 4 passwords** which create an unpredictable frequency hopping schedule and encryption keys.

Connecting to any channel



Open or Private

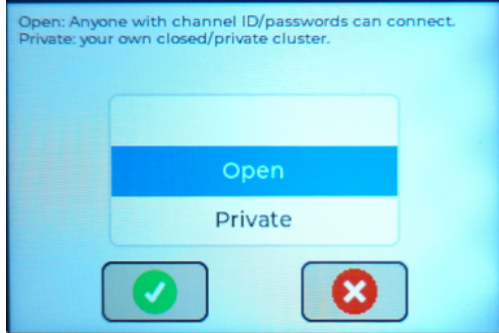

RF Zone

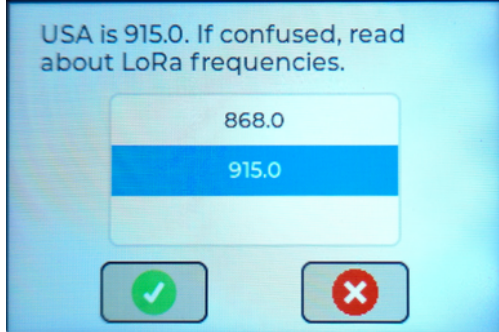

Custom or Default

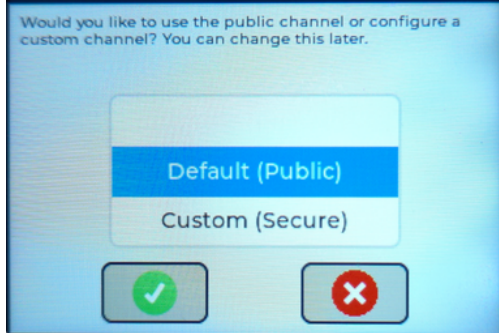

Switching Channels

Open settings and select the channel you want.



Nodes and Channels

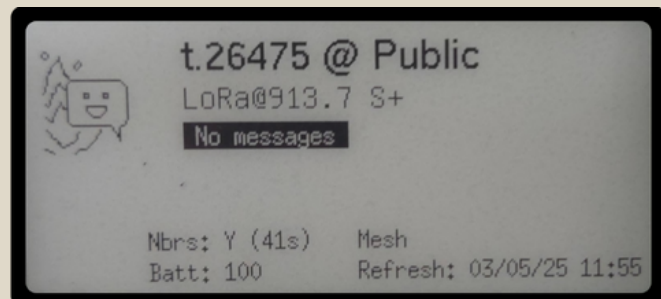

Nodes can act as message caches, repeaters, and displays for channels. To add a node to your channel, you must push the channel config from a communicator.

Connecting a Node to a Channel

- Connect a communicator to the channel
- Install the **Anon** node firmware to the node. If not using SD card, select to erase the node when installing.
- If using an SD card, ensure the node's SD card is empty
- Power on the node - it should be waiting to receive channel info from a communicator.
- On a communicator, choose: Settings / Channels / Send Channel
- Allow a minute or two for the node to be fully configured.